

WitaTrap® Complete European Cherry Fruit Fly Trap Set

Assembly of the WitaTrap® balloon trap:

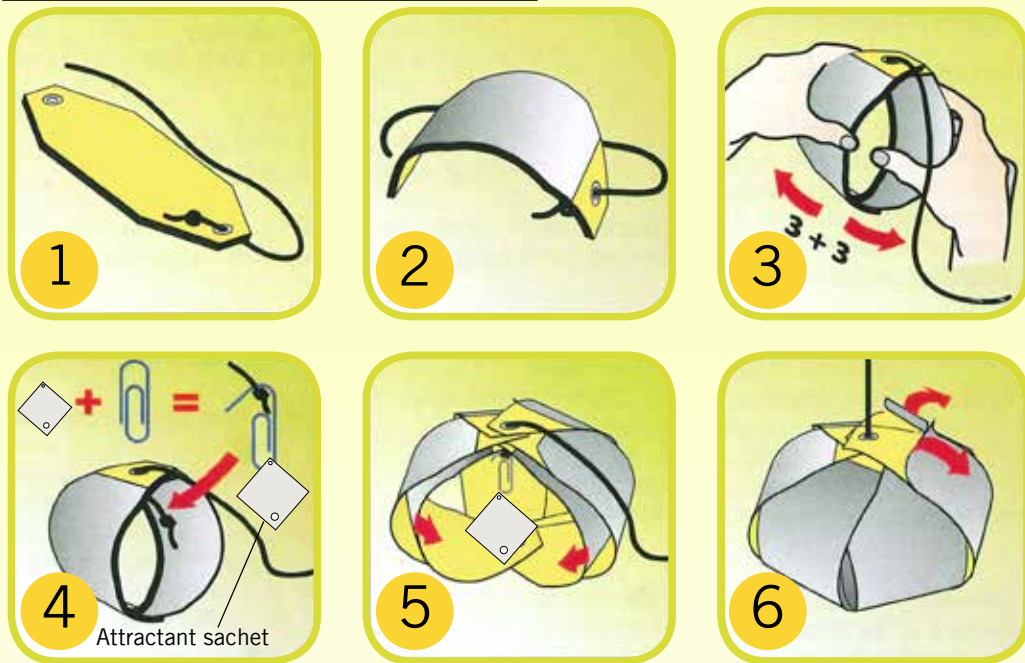

Assembly:

- 1 Lay the balloon trap out flat. Then bend the trap with the still covered adhesive surfaces upwards to give it a semicircular form.
- 2 Pull the adhesive surfaces apart. The suspension cord should be at the top and there should be at least three adhesive surfaces per side.

- 4 Remove the pheromone (attractant) from the aluminium sachet and attach it with the help of a paperclip to the centre of the balloon trap.

Important: only open the outer aluminium sachet - take care to avoid damaging the inner sachet containing the pheromone.

- 5 Once the pheromone is in place, fan out the adhesive surfaces left and right to form a balloon shape.
- 6 Now remove the protective films from the adhesive surfaces.
- 7 Suspend the assembled balloon trap in accordance with instructions. (See inside page)



Contents: One trap set

consisting of: 2 trap bodies (WitaTrap® Balloon Trap), 2 pheromone sachets (attractant) (separately packaged!), suspension cord for mounting and detailed instructions for use.

Art. No.: 343140



witasek®



© Chris Boswell - Fotolia.com

WitaTrap®



Complete European Cherry Fruit Fly Trap Set

For the control of cherry maggots

European cherry fruit fly (*Rhagoletis cerasi*)

Biological attractant trap (pheromone trap) for the management of pest infestation of your cultivars.

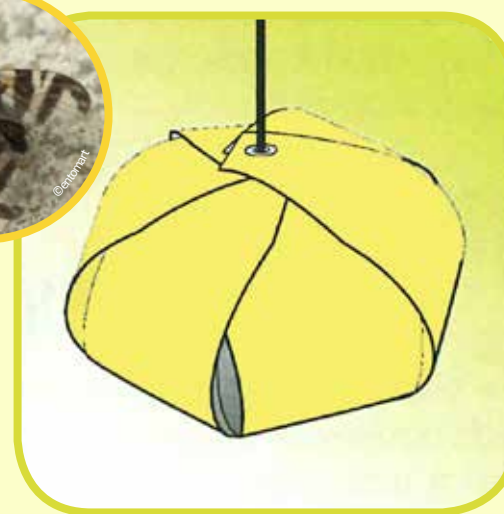

► See inside for more information

witasek® Witassek-Allee 2 • 9560 Feldkirchen/Austria • Tel.: +43 (0) 4276 / 3230
Fax: +43 (0) 4276 / 2088-399 • office@witasek.com • www.witasek.com

LEGAL NOTICE: Publisher responsible for contents: witasek PflanzenSchutz GmbH. Great care has been exercised in providing information. We can accept no liability for misprints and other errors. Contents may be subject to change without notice. Our general terms of supply and payment apply. To view our GTCs, go to www.witasek.com

European cherry fruit fly (*Rhagoletis cerasi*)

Pest: European cherry fruit fly
 Scientific name: *Rhagoletis cerasi*
 Infests: cherries



Main symptoms of infestation:

- Fallen fruits exhibit a brownish discoloured site in the stalk area
- Putrid, soft flesh around stones
- White, elongated larvae

Biology:

Overwinter in pupa form in soil.

The flies first appear from mid-May and lay individual eggs on semiripe fruits as they change colour (from “green” towards “yellow”).

The maggots hatch after 6 - 12 days and eat the fruit flesh. After several weeks of eating, maggots leave the fruits and fall to the ground.

Mainly damaged are medium to late ripening varieties.

Egg deposition: each female lays some 200 eggs

Larval development phase: Larvae hatch after 6 - 12 days

Flight phase: around early May to June (flies)

Ideal conditions for flight: 20 - 21°C; at temperatures under 16°C, egg laying ceases



The use of pheromone traps is an excellent way of controlling levels of flying pest insects and beetles.

Purpose of pheromone traps:

- They are used to monitor levels of infestation and to determine when adults are taking flight. Further suitable targeted measures (biological or standard plant protection methods) can then be initiated as necessary.
- Reduction of numbers of pest insects.

Use:

Assemble traps and suspend them from a branch on the upper third of tree crowns. (See other side for assembly instructions)

Experience shows that the ripening process begins first on the south side of trees, in the upper third of the crown. It is thus advisable to attach the traps to the external, sunny side of trees before the adults take flight.

The number of traps required depends on the size of each tree (2 - 10 traps may be needed).

Make sure the external adhesive surfaces are kept free of contact with branches and leaves.

Each trap should be checked at regular intervals of 2 - 3 days. Each time a trap is checked, the insects sticking to the adhesive surfaces should be removed using a suitable tool (e.g. twig or wooden scraper) to ensure that the full glue surface is revealed. If surfaces become very soiled, replace the trap or spray with a liquid glue, such as Soveurode special glue.

Replace the attractant (pheromone) and whole traps if necessary every 4 - 6 weeks.

*Traps should be put in place before the flight phase of the adults.

Storage:

Store the pheromones prior to use in the *original packaging* in a cold place (e.g. refrigerator or freezer compartment) at a maximum temperature of +4°C (no risk to foodstuffs).

Disposal:

Used traps can be disposed of with domestic waste.



Period of use*

Trap set

| Art. No. | Product |
|----------|---|
| 343140 | WitaTrap® Complete European Cherry Fruit Fly Trap Set (<i>Rhagoletis cerasi</i>) |

Reconditioning

If adhesive surfaces collect too many insects and traps become badly soiled, these should be replaced or resprayed with a liquid glue, such as Soveurode special glue.

| Art. No. | Product |
|----------|--|
| 381211 | Soveurode special glue (sprayable glue) |

Orders can be placed by phone, fax or email.

Tel.: +43 (0)4276/ 3230 | Fax: +43 (0) 4276/ 2088-399 | Email: office@witasek.com